

*Designers & Manufacturers of Drilling & Tapping Solutions*

## Drilling Head With One Fixed and Four Adjustable Spindles



Model 102-5D utilizes the existing thru drive with center spindle and four (4) eccentric spindles. With this unique design spindle coverage can provide: (a) two separate 2 spindle patterns from 31/32 minimum to 3 31/32 maximum, (b) three equally spaced holes from 1" minimum to 2.5 maximum, (c) four equally spaced holes on a 2" minimum bolt circle to 5" maximum bolt circle.

Stock units are supplied with 1 Jacobs taper spindles, 4700 series chucks 5/16" diameter maximum drill capacity and 3000 RPM maximum speed.

Model No.	Description	Center Distance		Type Spindle	Chuck Series	Capac. Spindle Mild Stl.	Vert. Adj.	Wt. Less Mtg.	Max. R.P.M.
		Min.	Max.						
102-5D	(5) Spindle Drilling Head	* 2" ** 1" *** 1"	5" 2 1/2" 5"	1 Jacobs	4703	5/16	.44	11 Lbs.-10 Oz.	3000

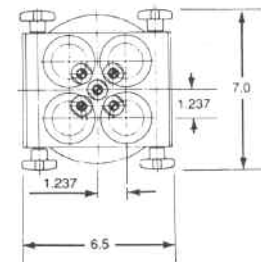
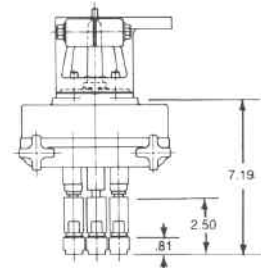

## Tapping Head With One Fixed and Four Adjustable Spindles

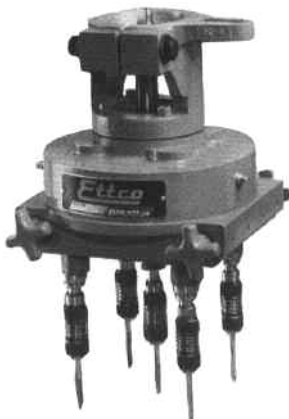

Model 102-5T also utilizes the existing thru drive with center spindle and four (4) eccentric spindles. Spindle coverage options are the same as for 102-5D. The 3/8" serrated spindles each have tapping capacity of 1/4 - 20 cutting taps in mild steel.

They are supplied with 4000 series chucks, and mount to Ettco 22H tapping attachments.

Model No.	Description	Center Distance		Type Spindle	Chuck Series	Capac. Spindle Mild Stl.	Vert. Adj.	Wt. Less Mtg.	Max. R.P.M.
		Min.	Max.						
102-5T	(5) Spindle Tapping Head	* 2" ** 1" *** 1"	5" 2 1/2" 5"	3/8 Ser.	4000	1/4-20	.25	11 Lbs.-10 Oz.	3000

- \* Bolt Circle With (4) Holes Equally Spaced
- \*\* Triangular Pattern With (3) Holes Equally Spaced
- \*\*\* Inline Pattern With (3) Holes Equally Spaced

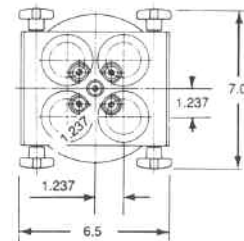
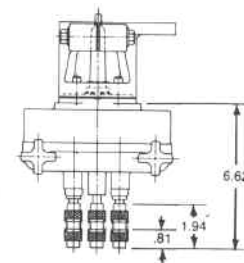

### Application

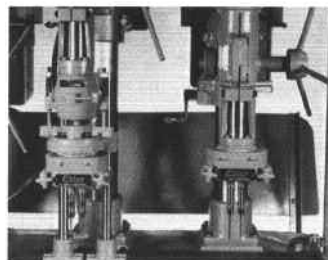

#### Old Machine

Right: Model 102-2D quill mounted to a common drill press  
 Left: Model 102-2T with Ettco 22H tapping face plate, quill mounted to a common drill press.  
 Guide rods and foot type mounting brackets provide rigidity.

Includes adaptation to drill press advise complete specification.